





METEOTRACKER APP FOR IOS



USER MANUAL

Quick guide

- ✓ **Download the MT App** from the Apple Store and install it.
- ✓ **Open it and login** (by Google, Facebook or Apple login).
- ✓ **Open the “Settings” menù** (tab in the footer) to set the distance between acquisitions (10-50 m recommended) and the units of measurement. Do not activate the “Enable session auto-recording function” (not operative yet).
- ✓ **Push the ON button of the MeteoTracker mini-weather station** (BT advertising → **green led** blinking) and place it externally on the vehicle (see **installation tips** on the MeteoTracker mini-weather station guide).
- ✓ **Press the “START” button to initiate a session.**
- ✓ **Enjoy your session** with real-time visualization of data acquired on map, graphs and numeric format.
- ✓ **To close the session**, press the  button in the right lower corner and then .
- ✓ **Visualize your session** pressing the tab “My sessions” in the footer.
- ✓ **Go to <http://app.meteotracker.com/#!/en>** to visualize your and other publicly visible sessions.

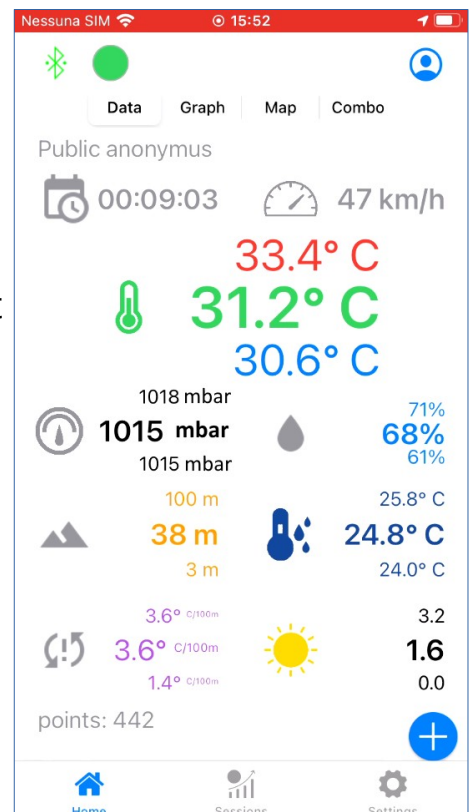

◆ ◆ FOR DETAILS SEE THE FOLLOWING PAGES ◆ ◆

Operations – detailed description

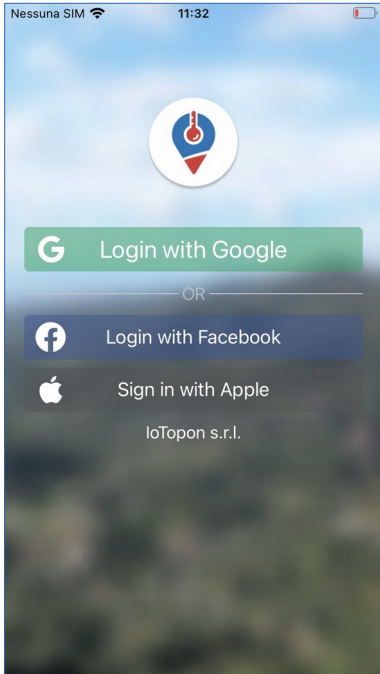

Login

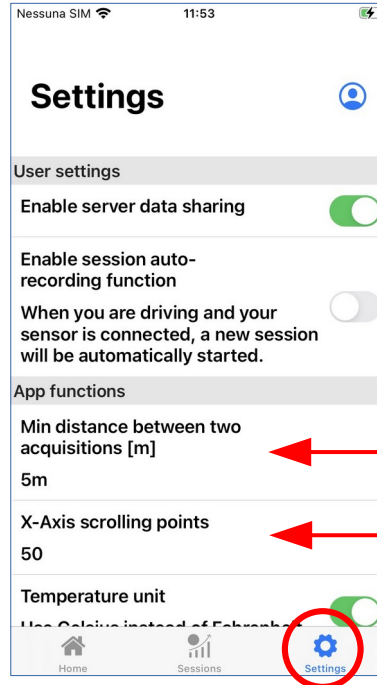

Settings

Keep it enabled

Keep it OFF

10 m- 50 m recommended value

Points in the graph when zoomed

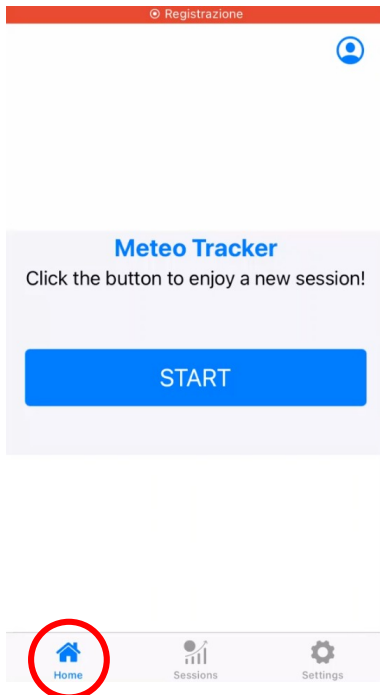

Session start

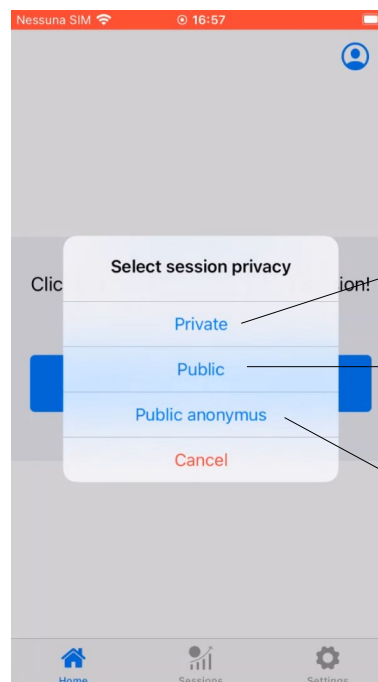

Visible to the session's author only

Visible to everybody with the nickname of the session's author

Visible to everybody without the nickname of the session's author

Activate first the ADV mode in the MeteoTracker mini-weather station (press the ON button → the green led will blink)

Operations – detailed description

Blinking green circle
 ↓
initial Guard Time
 After session startup, an initial “guard time” is automatically activate to make sure that the initial temperature data is not affected by the initial thermal status of the mini-station (for example, stored internally in the car at a much higher temperature than outside)

4 real-time visualization tabs
 “Data”, “Graph”, Map” and “Combo”

Menu opening

Session Guard Time

4 real-time visualization tabs “Data”, “Graph”, Map” and “Combo”

Real-time sharing
 A link to the session is generated to be shared by Whatsapp, email, etc.. Opening the link, the session can be viewed real-time on the web platform

MeteoPhoto shooting
 A picture is taken having the weather data measured in that instant + data&time + place tagged on it

Session pause
 To put the session on hold (data acquisition is stopped) – Green circle turns to orange

Real-time menù

Session closure
 To close the session

Battery level
 68

Bluetooth signal intensity
 -83

Battery and BT status

Operations – detailed description

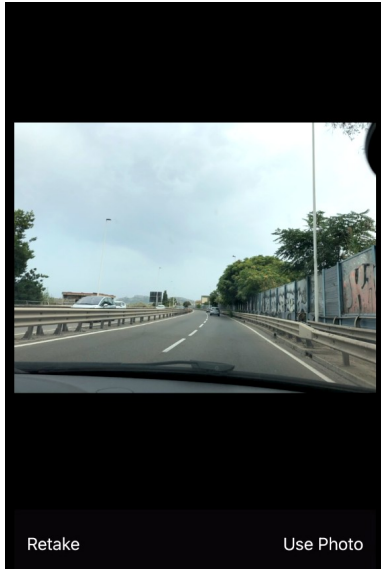

MeteoPhoto shooting



MeteoPhoto

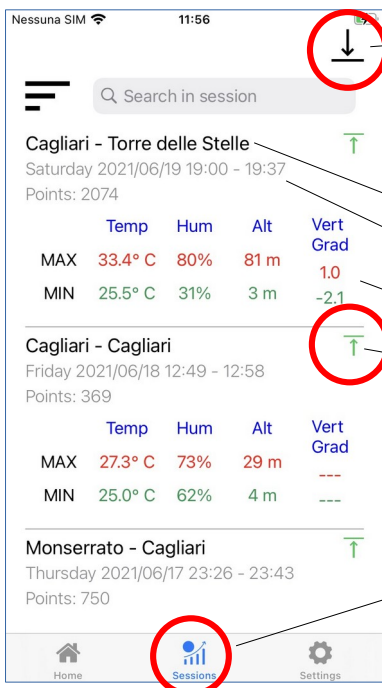

Sessions retrieving from the server

If you change iPhone or for any reason you lost your sessions in the iPhone, touch this arrow to recover the missing sessions from the server

Session identifier

Starting and arriving place

Date&time

Main statistics

Upload status

Green: upload to the server completed
Red: upload to be completed

In case of missing upload (red arrow), touch the arrow to push an upload instance

Archive tab

Archive -Sessions list

Operations – detailed description

Touch here to open the statistics page

Touch here to share the session by Whatsapp, email, etc....

Weather data of the selected point

Data visualization of each point

Touching a point in the map, the corresponding set of weather data is visualized (time, altitude, temperature, relative humidity and pressure) and spotted in the graph

Archive
Session visualization

Marker highlighted

Minimum, average and maximum values of each parameter are shown for each session

The Avg value of the Vertical temperature gradient is the RMS (Root Mean Square) value

Session statistics			
Temperature			
Min	Avg	Max	
24.0 °C	0.0 °C	27.0 °C	
Vertical temperature gradient			
Min	Avg	Max	
0.0 °C/100m	0.0 °C/100m	1.0 °C/100m	
Humidity			
Min	Avg	Max	
37.0%	44.0%	48.0%	
Dew Point			
Min	Avg	Max	
12.0 °C	0.0 °C	15.0 °C	
Altitude			
Min	Avg	Max	
4.0 m	15.0 m	38.0 m	
Pressure			
Min	Avg	Max	
1009.0mb	1011.0mb	1014.0mb	
Solar radiation			
Min	Avg	Max	
0	0	0	
Speed			
Min	Avg	Max	
0	55	96	

Session statistics

Real time view – Data tab

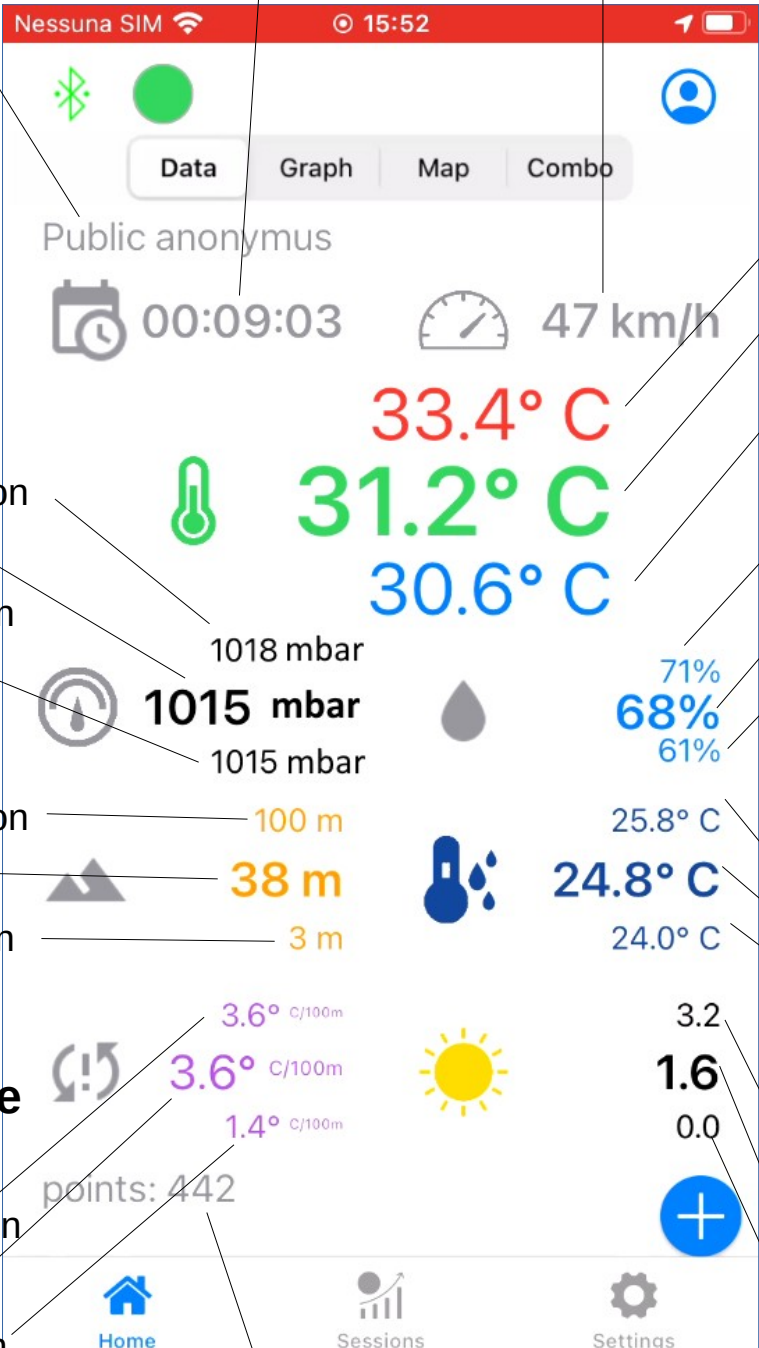

Session type

Session duration

Speed

Temperature

Max of the session
Current value
Min of the session

Relative humidity

Max of the session
Current value
Min of the session

Dew point

Max of the session
Current value
Min of the session

Solar radiation indicator

Max of the session
Current value
Min of the session

Pressure

Max of the session
Current value
Min of the session

Altitude

Max of the session
Current value
Min of the session

Vertical Temperature gradient

Max of the session
Current value
Min of the session

Points collected

1018 mbar
1015 mbar
1015 mbar

100 m
38 m
3 m

3.6° C/100m
3.6° C/100m
1.4° C/100m

points: 442

71%
68%
61%

25.8° C
24.8° C
24.0° C

3.2
1.6
0.0

00:09:03
47 km/h

33.4° C
31.2° C
30.6° C

Public anonymus

Nessuna SIM 15:52

Data Graph Map Combo

Home Sessions Settings

Real time view – Graph tab

Graph zoom selector

all points or last x points (x is set by the user in “Settings”)

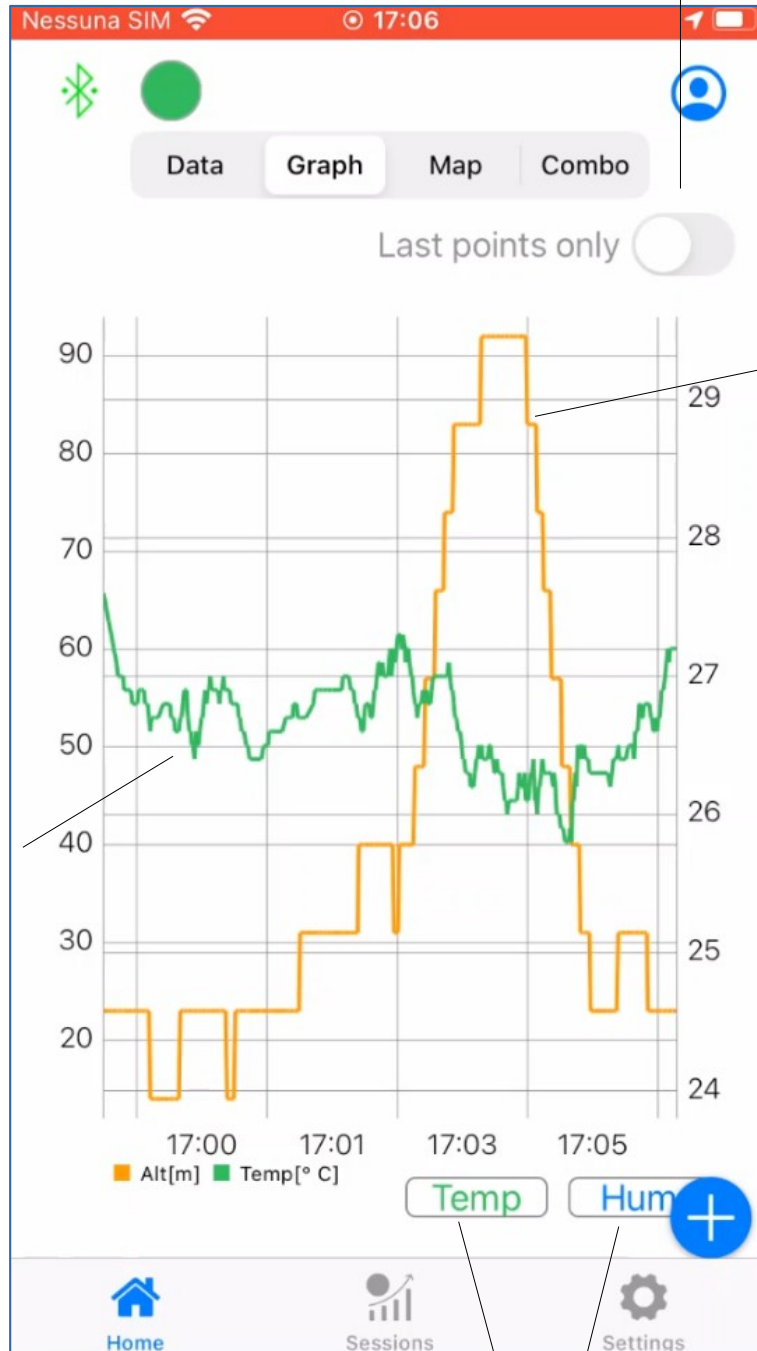

Altitude

Temperature

Graph selection

Real time view – Map tab



Marker

Touching a marker, the corresponding data are showed:

- ✓ temperature
- ✓ pressure
- ✓ relative humidity
- ✓ altitude
- ✓ time

Real time view – Combo tab

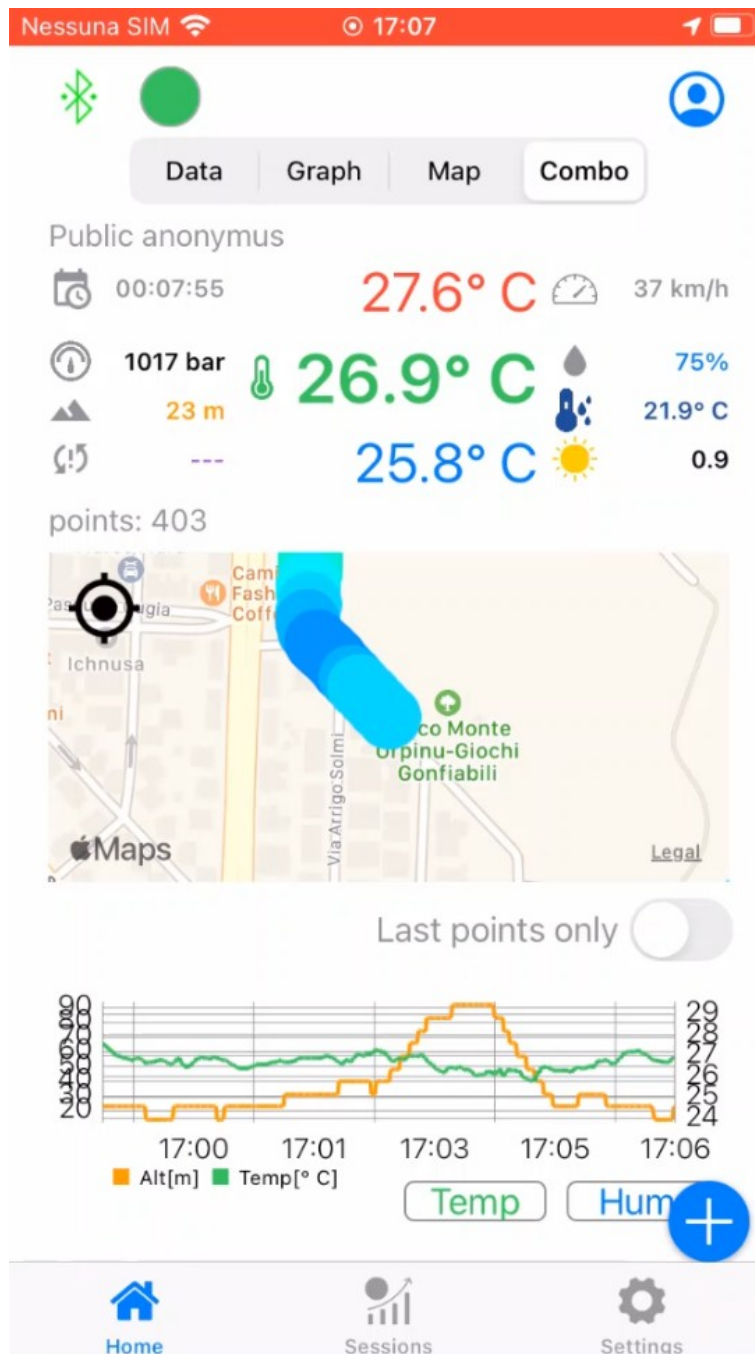

FEATURES

✓ Guard Time (GT)

What is

A time interval that is automatically set at the beginning of the session based on speed monitoring, during which data is not acquired, to prevent collecting low-accuracy values (first temperature data may be affected by the initial thermal status of the mini-station, for example, if stored internally in the car at a much higher temperature than outside).

Indicator

Blinking green circle in the left upper side of the screen

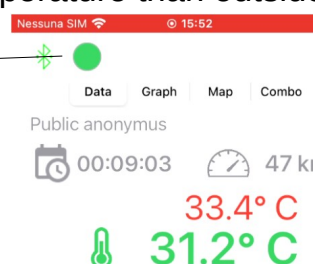

✓ Automatic Pause Time (APT)

What is

When the vehicle on which MeteoTracker is installed stops, the air layer above the car rooftop could get warmer due to the solar radiation and absence of ventilation. To prevent low-accuracy data acquisition, **the App automatically detects the abnormal temperature increase and stops the acquisition.**

When the vehicle restarts, data acquisition restarts as well, after a Guard Time interval.

Indicators

Green circle in the left upper side of the screen that turns to **orange** (APT activation)
Orange and **green** alternation when vehicle restarts (GT after vehicle restarts).

✓ Manual Pause Activation (MPA)

What is

Data acquisition stop during a session by touching the “pause” button in the real-time menu. When the pause is closed, acquisition is restarted after a Guard Time interval



Indicators

Green circle in the left upper side of the screen that turns to **orange** (MPA activation)
Orange and **green** alternation when vehicle restarts (GT after vehicle restarts)

✓ MeteoPhoto

What is

Activate iPhone camera to take a picture where weather data measured in that instant + location name and date&time are stamped on the header (landscape format) or in the footer (portrait format)

Indicator

iPhone camera activation



FEATURES

✓ Real-time session sharing

What is

When a real-time session is running, a link is generated by touching the sharing button and sharing options visualized (by WhatsApp, Telegram, email, etc...) to send the link to the designed person. Opening the link, the real-time session is visualized on the MeteoTracker web platform.



✓ Archive session sharing

Opening a session from the archive and touching the sharing button on the upper right corner, a link is generated and sharing options visualized (by WhatsApp, Telegram, email, etc...) to send the link to the designed person.

Opening the link, the session is visualized on the MeteoTracker web platform.

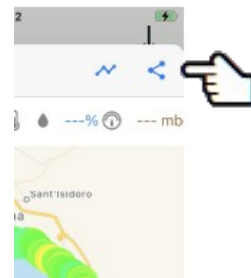

REFERENCES

- ✓ www.meteotracker.com
- ✓ facebook.com/meteotracker
- ✓ www.linkedin.com/showcase/meteotracker
- ✓ [email: meteotracker@meteotracker.com](mailto:meteotracker@meteotracker.com)
- ✓ www.youtube.com/channel/UCioWABj-yL-FeRkACVpjTmQ/videos